

BALL-TYPE FAUCETS

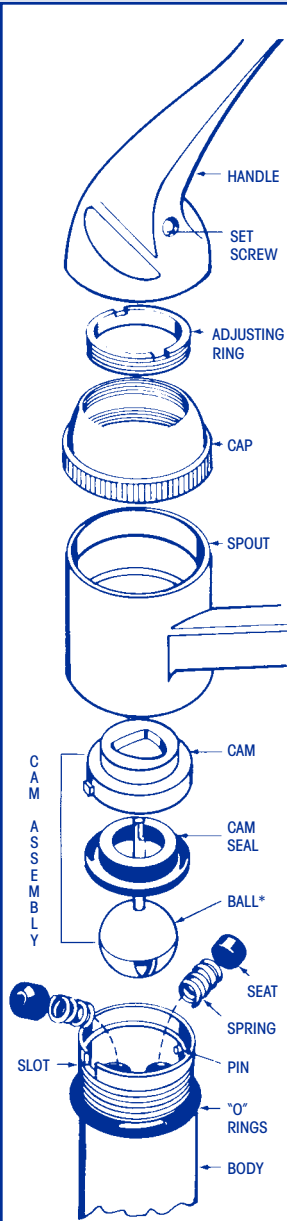

1. Shut off water supply valves then drain lines by turning faucet on.
2. Use an allen wrench to loosen the set screw holding the handle in place and remove handle.
3. Loosen and remove the adjusting ring by using the special wrench provided in the repair kit.
4. To remove cap, use pliers and turn counterclockwise. Protect cap finish with cloth.
5. Remove spout assembly.
6. Remove cam assembly by pulling up on ball shaft. You may need to use pliers.
7. Removing seats and springs is best done by inserting a pencil or sharp tool into the seat assembly and gently lifting it out. Check and clean inlet ports before replacing seats and springs.
8. To replace "O" rings on body, use a sharp tool to pry away from body. Roll new correct size "O" ring into place.
9. When reassembling, be sure to align slot in ball with pin in body and key on cam with slot in body.
10. Hand-tighten the cap, then screw adjusting ring into place with special wrench and replace handle. Turn on water and check for leaks. If necessary, further tighten adjusting ring.

* Recommended to use Delta genuine replacement parts.
 * When replacing the ball, it is recommended to use the genuine Stainless steel ball (#SL0103)

TROUBLESHOOTING

STYLE	PROBLEM	CAUSE	SOLUTION
STEM-TYPE FAUCET	Water drips from faucet spout	Worn or damaged seat washer	Replace
		Corroded or worn seat	Regrind/Replace
		Worn or damaged stem washer	Replace
		Worn stem	Replace
	Water leaks from handle base	Worn seat diaphragm	Replace
		Worn or damaged "O" rings	Replace
Faucet chatters or squeals when used	Worn stem packing	Replace	
	Loose or damaged stem screw	Tighten or Replace	
	Loose stem	Tighten	
BALL-TYPE FAUCET	Water drips from faucet spout	Worn or damaged seats	Replace
		Weak springs	Replace
		Worn or damaged ball	Replace
BALL-TYPE FAUCET	Leakage at spout handle	Worn cam	Replace
		Worn cam seal	Replace
	Leakage at bottom of spout handle	Loose or damaged adjusting ring	Tighten if loose; Replace if damaged
CARTRIDGE FAUCET	Water drips from faucet spout	Worn or damaged "O" rings	Replace
		Corroded or worn cartridge	Replace
CARTRIDGE FAUCET	Leakage at faucet handle	Worn or damaged "O" rings	Replace
DISC FAUCET	Water leaks from spout or handle	Worn or damaged disc seals	Replace

CARTRIDGE-TYPE FAUCETS

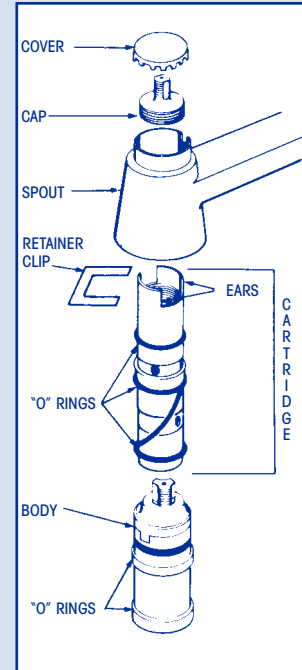

1. Shut off water supply valves then drain lines by turning faucet on.
2. Remove decorative cap and remove screw cap.
3. Pull spout assembly off.
4. Pull retainer clip from its slot.
5. Note position of cartridge ears so that when replacing, they are in identical position. Using pliers, lift cartridge out of body.
6. Remove "O" rings by prying away from body and rolling new ones into place, or replace entire cartridge.
7. Reverse procedure for reassembly.

DISC-TYPE FAUCETS

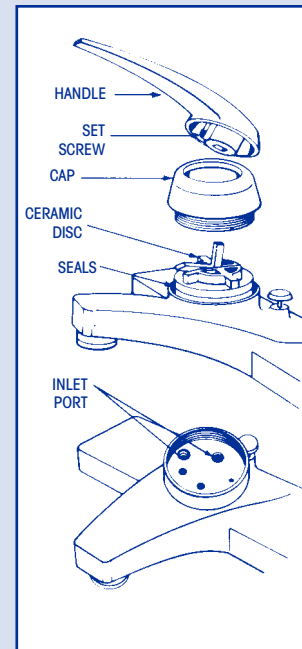

1. Shut off water supply valves then drain lines by turning faucet on.
2. Lift handle up as far as possible and loosen set screw.
3. Lift handle off and unscrew cap.
4. Loosen screw holding ceramic disc cartridge in body and lift cartridge out.
5. On underside of cartridge are the set of seals that should be replaced. Check and clean inlet ports.
6. Reassemble by reversing above procedure, being sure cartridge holes align with inlet ports.